



VOKES AIR

Taking small steps together, always ahead, towards a better world

GDM

Filter housing





GDM

Filter housing

The GDM filter housings are standard module constructed casings, designed to fit all Vokes Air bag filters, all types of compact filters and most carbon filter cassettes.

APPLICATIONS



Clean Air



Power Generation



Clean Room



Industrial

KEY FACTS

- ▶ **Modular design**
For seamless integration with a variety of operational environments
- ▶ **Parallelogram fitted filters**
Ensures absolutely air tight filter installation
- ▶ **Constructed from galvanised steel**
For excellent strength and rigidity
- ▶ **Side access and inspection door**
Simplifies filter install and maintenance
- ▶ **Compatible with the entire product range G3 – F9 and most carbon filters**
For simple installation and utmost flexibility



GDM Filter Housing

The GDM filter housing is produced in sections of galvanized steel sheet. As standard it comes uninsulated or insulated with double-walls and intermediate insulation (EI 30). The airtight side-access inspection door moves on hinges and is equipped with solid handles (as option with lock). Differential pressure connections for pressure drop measurements with pressure gauge are standard. The filters are fitted with a parallelogram that ensures absolute air-tightness. Both flange and PG joint duct connections are available.

The GDM housing is as option also available in stainless steel or epoxy coated.



▲ The filter cassette is installed from the side-access inspection door



▲ The fitting of the air filter with parallelogram towards the gasket ensure airtightness

Available Variants

GDM-FK-S

for bag filters G2-F9

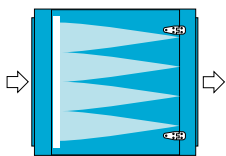

GDM-FK-K

for compact filter F6-F9 and carbon filter AFP-AZ

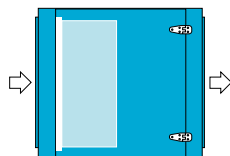

GDM-FK is designed for various types of filter cassettes. The filters are fitted into the casing through the side-access hatch and pressed with the parallelogram towards the gasket for efficient tightening. The inspection door can only be closed with the handle in locked position, which guarantee air-tightness.

GDM KK-C

for Scandsorb carbon cylinders

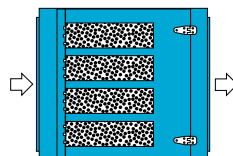

GDM KK-C is designed for Scandsorb cylinders filled with activated carbon or the impregnated spheres Unisorb Mark 2. The cylinders are fitted with bayonet joints on to the mounting plate inside the housing. The intermediate gasket ensures airtightness. The cylinders can be refilled with carbon.

GDM KK-TK

for Odorex carbon cassettes

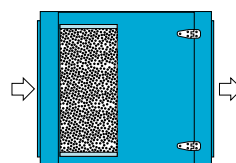

GDM KK-TK is designed for Odorex carbon filter cassettes type CF1 and CF2. The Odorex cassettes are fitted in the same way as the other filter cassettes with parallelogram. The Odorex filters are exchangeable cassettes with a galvanized steel sheet casing.



Dwelling time:
Carbon – 0.12 secs
Unisorb. – 0.6 secs

| Size | No. of filters, module | | | Nominal Flow (m ³ /s) | No. of Cylinders | Activated Carbon (ℓ) | Nominal Flow (m ³ /s) | Unisorb Spheres (litre) | Nominal Flow (m ³ /s) |
|-----------|------------------------|-----|-----|----------------------------------|------------------|----------------------|----------------------------------|-------------------------|----------------------------------|
| | 1/4 *) | 1/2 | 1/1 | | | | | | |
| 0.5 x 0.5 | 1 | – | – | 0.24 | 4 | 16 | 0.14 | 16 | 0.028 |
| 0.5 x 1 | – | 1 | – | 0.47 | 8 | 32 | 0.28 | 32 | 0.055 |
| 0.5 x 1.5 | 1 | 1 | – | 0.71 | 12 | 48 | 0.42 | 48 | 0.084 |
| 0.5 x 2 | – | 2 | – | 0.94 | 16 | 64 | 0.56 | 64 | 0.11 |
| 0.5 x 2.5 | 1 | 2 | – | 1.18 | 20 | 80 | 0.70 | 80 | 0.14 |
| 0.5 x 3 | – | 3 | – | 1.41 | 24 | 96 | 0.84 | 96 | 0.16 |
| 1 x 0.5 | – | 1 | – | 0.47 | 8 | 32 | 0.28 | 32 | 0.055 |
| 1 x 1 | – | – | 1 | 0.94 | 16 | 64 | 0.56 | 64 | 0.11 |
| 1 x 1.5 | – | 1 | 1 | 1.41 | 24 | 96 | 0.84 | 96 | 0.16 |
| 1 x 2 | – | – | 2 | 1.88 | 32 | 128 | 1.12 | 128 | 0.21 |
| 1 x 2.5 | – | 1 | 2 | 2.35 | 40 | 160 | 1.40 | 160 | 0.27 |
| 1 x 3 | – | – | 3 | 2.82 | 48 | 192 | 1.68 | 192 | 0.32 |
| 1.5 x 0.5 | 1 | 1 | – | 0.71 | 12 | 48 | 0.42 | 48 | 0.084 |
| 1.5 x 1 | – | 1 | 1 | 1.41 | 24 | 96 | 0.84 | 96 | 0.16 |
| 1.5 x 1.5 | 1 | 2 | 1 | 2.12 | 36 | 144 | 1.26 | 144 | 0.24 |
| 1.5 x 2 | – | 2 | 2 | 2.82 | 48 | 192 | 1.68 | 192 | 0.32 |
| 1.5 x 2.5 | 1 | 3 | 2 | 3.53 | 60 | 240 | 2.10 | 240 | 0.40 |
| 1.5 x 3 | – | 3 | 3 | 4.23 | 72 | 288 | 2.52 | 288 | 0.48 |
| 2 x 0.5 | – | 2 | – | 0.94 | 16 | 64 | 0.56 | 64 | 0.11 |
| 2 x 1 | – | – | 2 | 1.88 | 32 | 128 | 1.12 | 128 | 0.21 |
| 2 x 1.5 | – | 2 | 2 | 2.82 | 40 | 160 | 1.40 | 160 | 0.27 |
| 2 x 2 | – | – | 4 | 3.76 | 64 | 256 | 2.24 | 256 | 0.42 |
| 2 x 2.5 | – | 2 | 4 | 4.70 | 80 | 320 | 2.80 | 320 | 0.53 |
| 2 x 3 | – | – | 6 | 5.64 | 96 | 384 | 3.36 | 384 | 0.64 |
| 2.5 x 0.5 | 1 | 2 | – | 1.18 | 20 | 80 | 0.70 | 80 | 0.14 |
| 2.5 x 1 | – | 1 | 2 | 2.35 | 40 | 160 | 1.40 | 160 | 0.27 |
| 2.5 x 1.5 | 1 | 3 | 2 | 3.53 | 60 | 240 | 2.10 | 240 | 0.40 |
| 2.5 x 2 | – | 2 | 4 | 4.70 | 80 | 320 | 2.80 | 320 | 0.53 |
| 2.5 x 2.5 | 1 | 4 | 4 | 5.88 | 100 | 400 | 3.50 | 400 | 0.67 |
| 2.5 x 3 | – | 3 | 6 | 7.05 | 120 | 480 | 4.20 | 480 | 0.80 |
| 3 x 0.5 | – | 3 | – | 1.41 | 24 | 96 | 0.84 | 96 | 0.16 |
| 3 x 1 | – | – | 3 | 2.82 | 48 | 192 | 1.68 | 192 | 0.32 |
| 3 x 1.5 | – | 3 | 3 | 4.23 | 72 | 288 | 2.52 | 288 | 0.48 |
| 3 x 2 | – | – | 6 | 5.64 | 96 | 384 | 3.36 | 384 | 0.64 |
| 3 x 2.5 | – | 3 | 6 | 7.05 | 120 | 480 | 4.20 | 480 | 0.80 |
| 3 x 3 | – | – | 9 | 8.46 | 144 | 576 | 5.04 | 576 | 0.96 |

GDM KK-TK

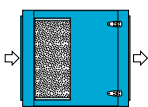

Dwelling time:
0.04 secs

| Size | No. of Cassettes CF1 | | Activated Carbon (ℓ) | Nominal Flow (m ³ /s) | No. of Cassettes CF2 | | Activated Carbon (ℓ) | Nominal Flow (m ³ /s) |
|---------|----------------------|-----|----------------------|----------------------------------|----------------------|-----|----------------------|----------------------------------|
| | 1/2 | 1/1 | | | 1/2 | 1/1 | | |
| 0.5 x 1 | 1 | – | 10 | 0.24 | 1 | – | 20 | 0.47 |
| 0.5 x 2 | 2 | – | 20 | 0.47 | 2 | – | 40 | 0.94 |
| 1 x 1 | – | 1 | 20 | 0.47 | – | 1 | 40 | 0.94 |
| 1 x 2 | – | 2 | 40 | 0.94 | – | 2 | 80 | 1.88 |
| 1.5 x 1 | 1 | 1 | 30 | 0.71 | 1 | 1 | 60 | 1.41 |
| 1.5 x 2 | 2 | 2 | 60 | 1.41 | 2 | 2 | 120 | 2.82 |
| 2 x 1 | – | 2 | 40 | 0.94 | – | 2 | 80 | 1.88 |
| 2 x 2 | – | 4 | 80 | 1.88 | – | 4 | 160 | 3.76 |

Note: For carbon filter cassette Scandsorb V25 and V75, use Filter housing GDR.

Dimensions

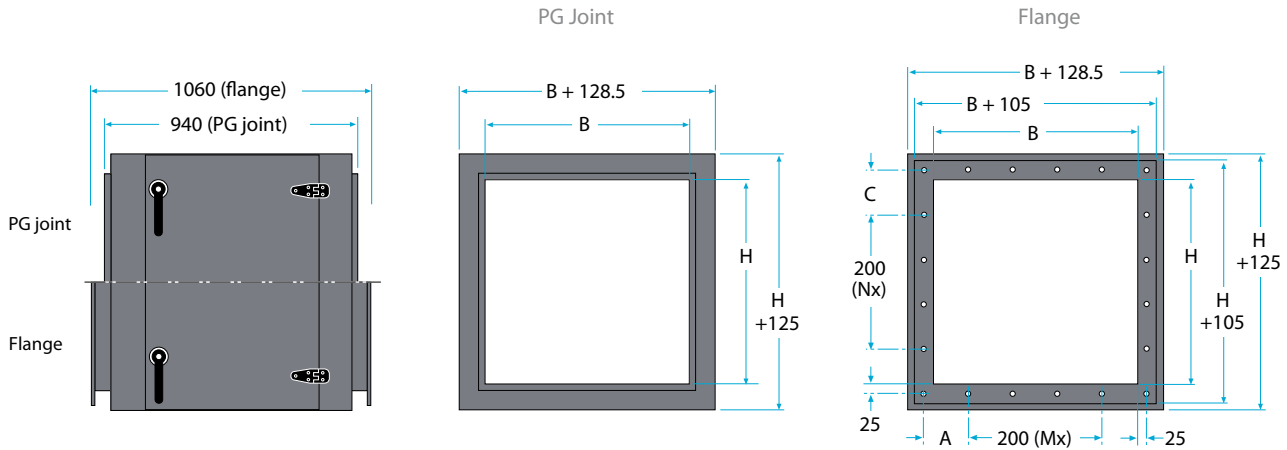

| Width (W) | Height (H) | | | | | |
|-------------|------------|---------|-----------|---------|-----------|---------|
| | 310 | 615 | 920 | 1225 | 1530 | 1835 |
| 325 | 0.5 x 0.5 | 0.5 x 1 | 0.5 x 1.5 | 0.5 x 2 | 0.5 x 2.5 | 0.5 x 3 |
| 625 | 1 x 0.5 | 1 x 1 | 1 x 1.5 | 1 x 2 | 1 x 2.5 | 1 x 3 |
| 925 | 1.5 x 0.5 | 1.5 x 1 | 1.5 x 1.5 | 1.5 x 2 | 1.5 x 2.5 | 1.5 x 3 |
| 1225 | 2 x 0.5 | 2 x 1 | 2 x 1.5 | 2 x 2 | 2 x 2.5 | 2 x 3 |
| 1525 | 2.5 x 0.5 | 2.5 x 1 | 2.5 x 1.5 | 2.5 x 2 | 2.5 x 2.5 | 2.5 x 3 |
| 1825 | 3 x 0.5 | 3 x 1 | 3 x 1.5 | 3 x 2 | 3 x 2.5 | 3 x 3 |

| B | A | M | H | C | N |
|------------|-------|---|------------|-------|---|
| 1 | 137.5 | 2 | 1 | 132.5 | 2 |
| 1.5 | 187.5 | 3 | 1.5 | 185 | 3 |
| 2 | 137.5 | 5 | 2 | 137.5 | 5 |
| 2.5 | 187.5 | 6 | 2.5 | 190 | 6 |
| 3 | 137.5 | 8 | 3 | 142.5 | 8 |

Weight and flange drawings available on request.

How to order:

- 1 pcs Filter housing GDM-FK-S, insulated, size 2 x 2, Type of fitting: Flange
- 4 pcs Synsafe bagfilter F7



OUR LOCATIONS

ÖSTERREICH

Tel: +43 (0) 1 698 66 77 0

FRANCE

Tel: +33 (0) 164 076 125

ITALIA

Tel: +39 022 692 6321

SOUTH AFRICA

Tel: +27 (0) 114 250 470

SVERIGE

Tel: +46 (0) 325 661 600

UNITED KINGDOM

Tel: +44 (0) 1282 686 266

DANMARK

Tel: +45 364 966 00

SCHWEIZ

Tel: +41 (0) 433 992 700

NEDERLAND

Tel: +31 888 653 724

DEUTSCHLAND

Tel: +49 (0) 2339 128 00
oder +49 (0) 6181 9082 01

ESPAÑA

Tel: +34 937 522 718

In view of continuous research and development we reserve the right to modify specifications and dimensions without prior notice. For quoted standards, the issue valid at the print date of this leaflet is relevant.
© Vokes Air • 02/2011 • EN • 0040

www.vokesair.com



Taking small steps together, always ahead, towards a better world